

# 电流继电器说明书

## Current Relay Specification

### 1.用途 USE

JL10 系列集成电路电流继电器是静态型交流电流继电器。用于发电机，变压器和输电线的继电保护装置中，作为电力系统交流回路过负荷或短路的启动元件，给出报警信号或切除故障。

JL10 series IC current relay is static type AC current relay. Used in relay protection devices for generators, transformers and transmission lines, as a starting element for AC return load or short circuit in power systems, giving alarm signals or removing faults.

本系列产品是专为替代 DL 系列继电器而设计的升级产品。该产品同时具备精度高，功耗小，动作时间快，返回系数高，整定直观方便，整定范围宽以及作为低电压使用时无抖动现象等优点。

This series of products is designed to replace the DL series relay upgrade products. The product has the advantages of high precision, low power consumption, fast action time, high return coefficient, convenient setting, wide tuning range and no jitter when used as low voltage.

#### 产品概述 Product overview

### 2 主要技术参数 Main technical parameters

1. 电流整定范围 Current setting range

a) A:0.5-9.99A A:0.5-9.99A

2. 功率消耗 Power consumption

a) 交流回路功耗 AC circuit power consumption

b) 直流回路功耗 DC circuit power consumption

3. 动作时间 Actuation Time

1 倍整定值的动作时间不大于 40ms ;2 倍整定值的动作时间不大于 35ms.

The action time of 1 times setting value is not more than 40 Ms;2 times the action time of setting value is not more than 35 Ms.

4. 返回时间: 不大于 27ms Return time: no greater than 27ms

5. 返回系数: 0.85-0.96 Return coefficient: 0.85-0.96

#### 产品参数 Product parameters

### 3.内部接线图

#### Internal wiring diagram

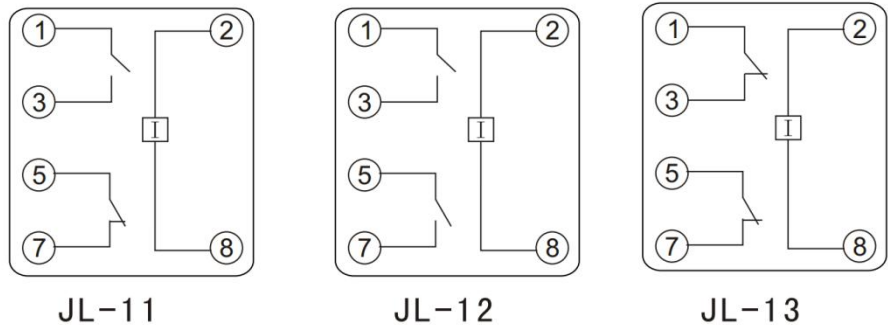

### 4.安装尺寸图 Mounting dimension diagram

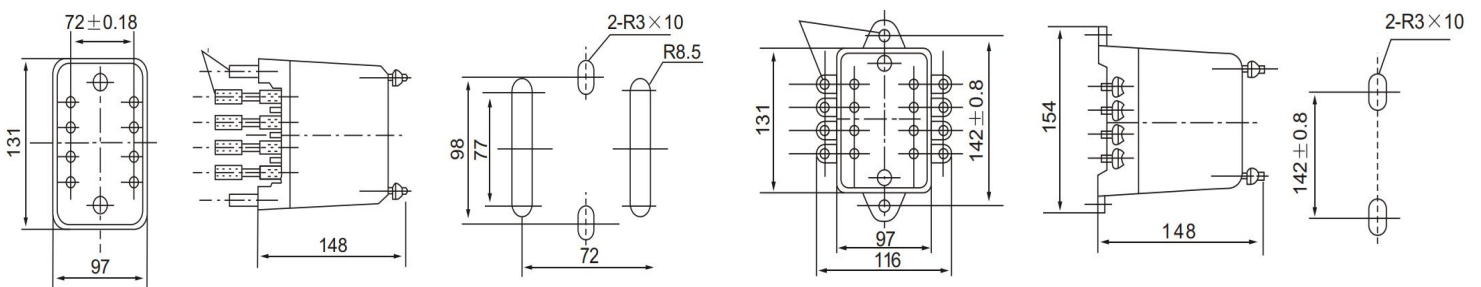

凸出式固定（后接线）Protruding fixing (rear connection)

凸出式固定（后接线）Protruding fixing (front connection)